

OFFICE SPACE FOR LEASE ACUTRONIC BUILDING

Washington's Landing, Pittsburgh, 15222



Property Highlights

- ▶ Existing open floor plan with perimeter offices
- ▶ Very clean - move in condition
- ▶ Secure building in a park-like setting, close to downtown Pittsburgh
- ▶ Great access to major highways
- ▶ Large conference/training room with kitchen

Space Available

10,000 square foot office space

For further information contact

Martha Graham
Massaro Properties, LLC
120 Delta Drive . Pittsburgh PA 15238
T. 412.963.2800 F. 412.449.0020
mgramham@massaroproperties.com



Massaro

www.massaroproperties.com

This statement, with the data it contains, is given with the understanding that all negotiations regarding the lease or purchase of the property described herein shall be channeled through this office. The information provided, while not guaranteed, has been obtained from the sources believed to be reliable. It is submitted subject to change or withdrawal without notice.

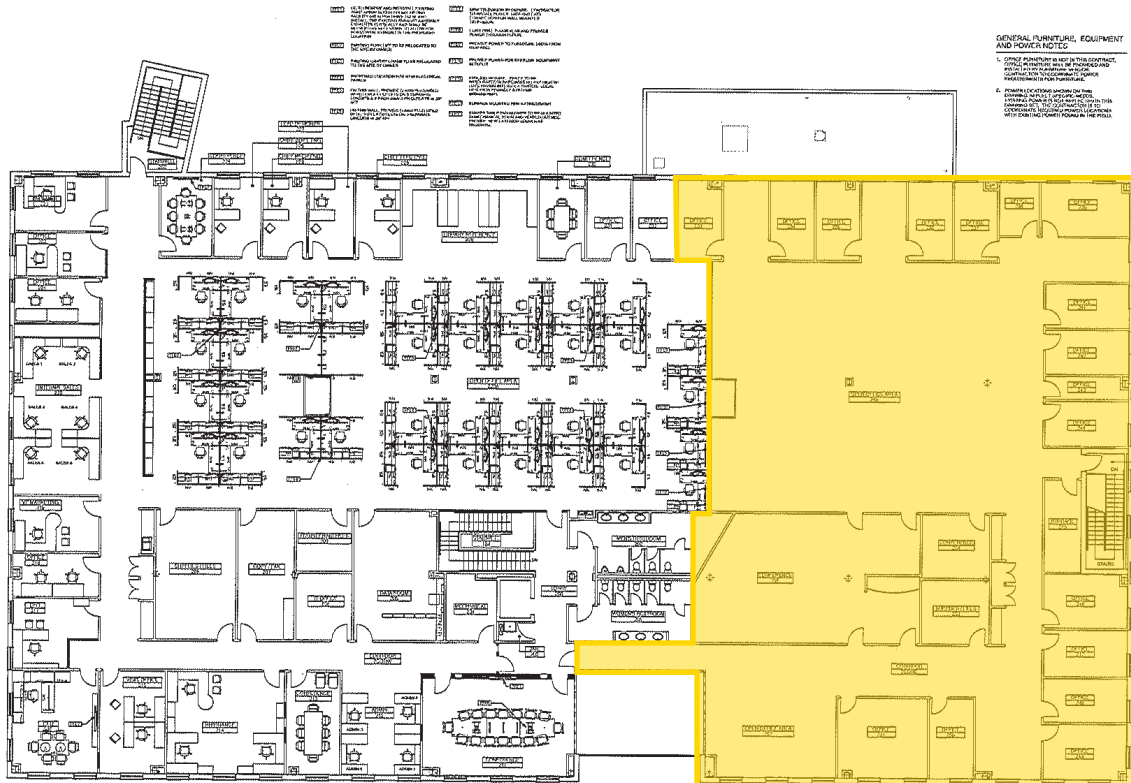
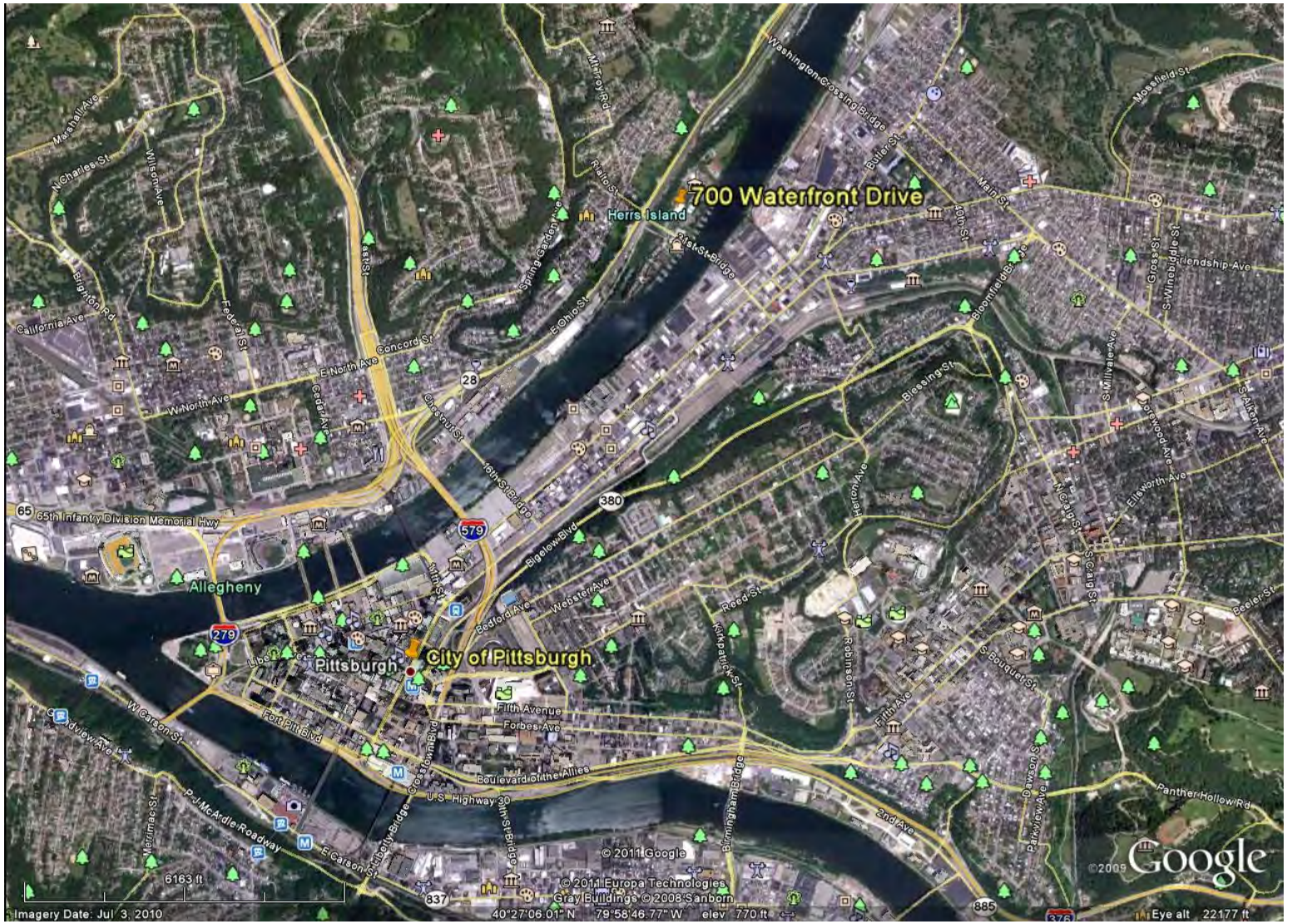

1 Second Floor Furniture, Fixture, Equipment and Partial Power Plan

GENERAL FURNITURE, EQUIPMENT AND POWER NOTE:
 1. Client's furniture is not in this contract. Client's furniture is to be provided by the client. The contractor shall provide the furniture and equipment as shown on the drawings. The contractor shall provide the power as shown on the drawings. The contractor shall provide the furniture and equipment as shown on the drawings. The contractor shall provide the power as shown on the drawings.

4 Smithfield Street Floor 12
 Pittsburgh, Pennsylvania 15222
 412.281.0001 412.281.0002

- general notes**
1. All work shall be in accordance with the drawings and specifications.
 2. The contractor shall provide the furniture and equipment as shown on the drawings.
 3. The contractor shall provide the power as shown on the drawings.
 4. All work shall be completed by the date specified in the drawings.
 5. The contractor shall provide the furniture and equipment as shown on the drawings.
 6. The contractor shall provide the power as shown on the drawings.
- schedule**
- 08.13.10 Issued for Pricing
 - 09.29.10 Issued for Scheduling
 - 10.17.10 Issued for Pricing
 - 10.19.10 Issued for Permit
 - 11.07.10 Revision 1
 - 11.09.10 Revision 2
 - 11.11.10 Power Plans
 - 11.29.10 Add Signs and Post Gaslight ducts

Client:
 Acumatic USA, Inc.
 4400 Allegheny Drive
 Pittsburgh, PA 15238

Project Location:
 Acumatic
 Washington's Landing
 700 Waterfront Drive
 Pittsburgh, PA 15222

Second Floor Furniture, Fixture, Equipment and Partial Power Plan

As Noted	Sheet No.
11/11/2010	A205
13 26	Project #1053