

OFFICE SPACE FOR LEASE ACUTRONIC BUILDING

Washington's Landing, Pittsburgh, 15205



Property Highlights

- ▶ Existing open floor plan with perimeter offices
- ▶ Very clean - move in condition
- ▶ Secure building in a park-like setting, close to downtown Pittsburgh
- ▶ Great access to major highways
- ▶ Large conference/training room with kitchen

Space Available

10,000 square foot office space

For further information contact

Martha Graham
Massaro Properties, LLC
120 Delta Drive . Pittsburgh PA 15238
T. 412.963.2800 F. 412.449.0020
mgramham@massaroproperties.com



Massaro

www.massaroproperties.com

This statement, with the data it contains, is given with the understanding that all negotiations regarding the lease or purchase of the property described herein shall be channeled through this office. The information provided, while not guaranteed, has been obtained from the sources believed to be reliable. It is submitted subject to change or withdrawal without notice.

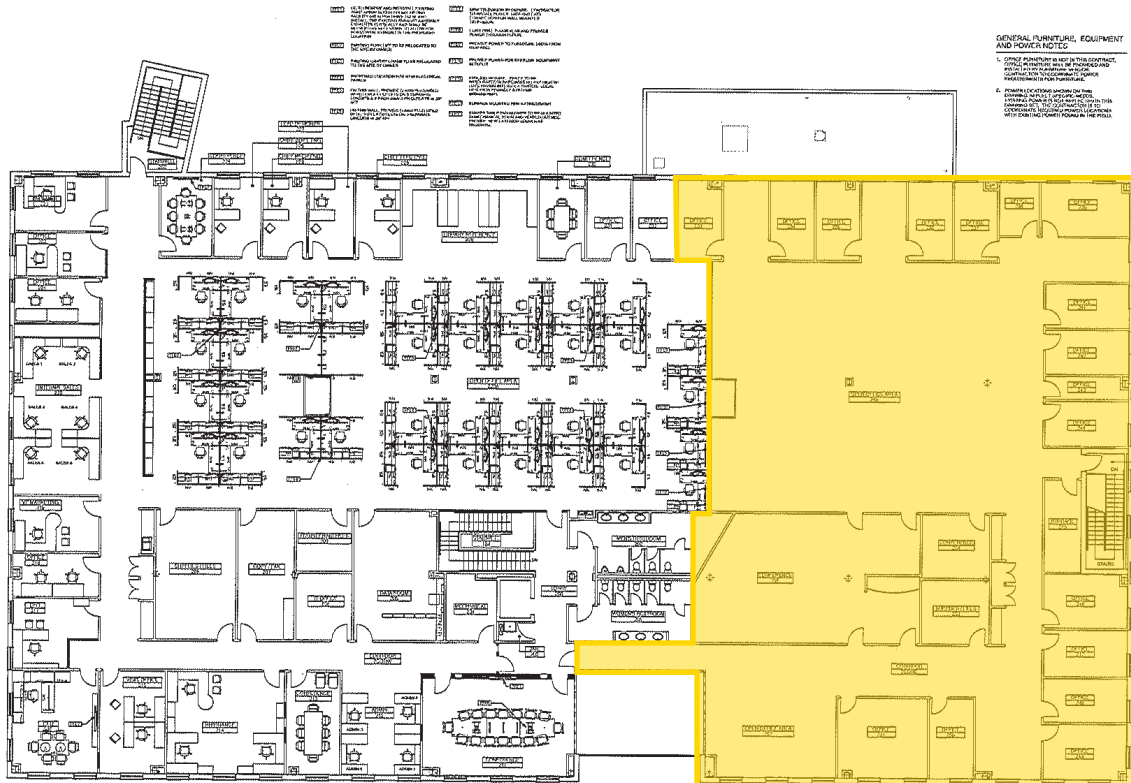
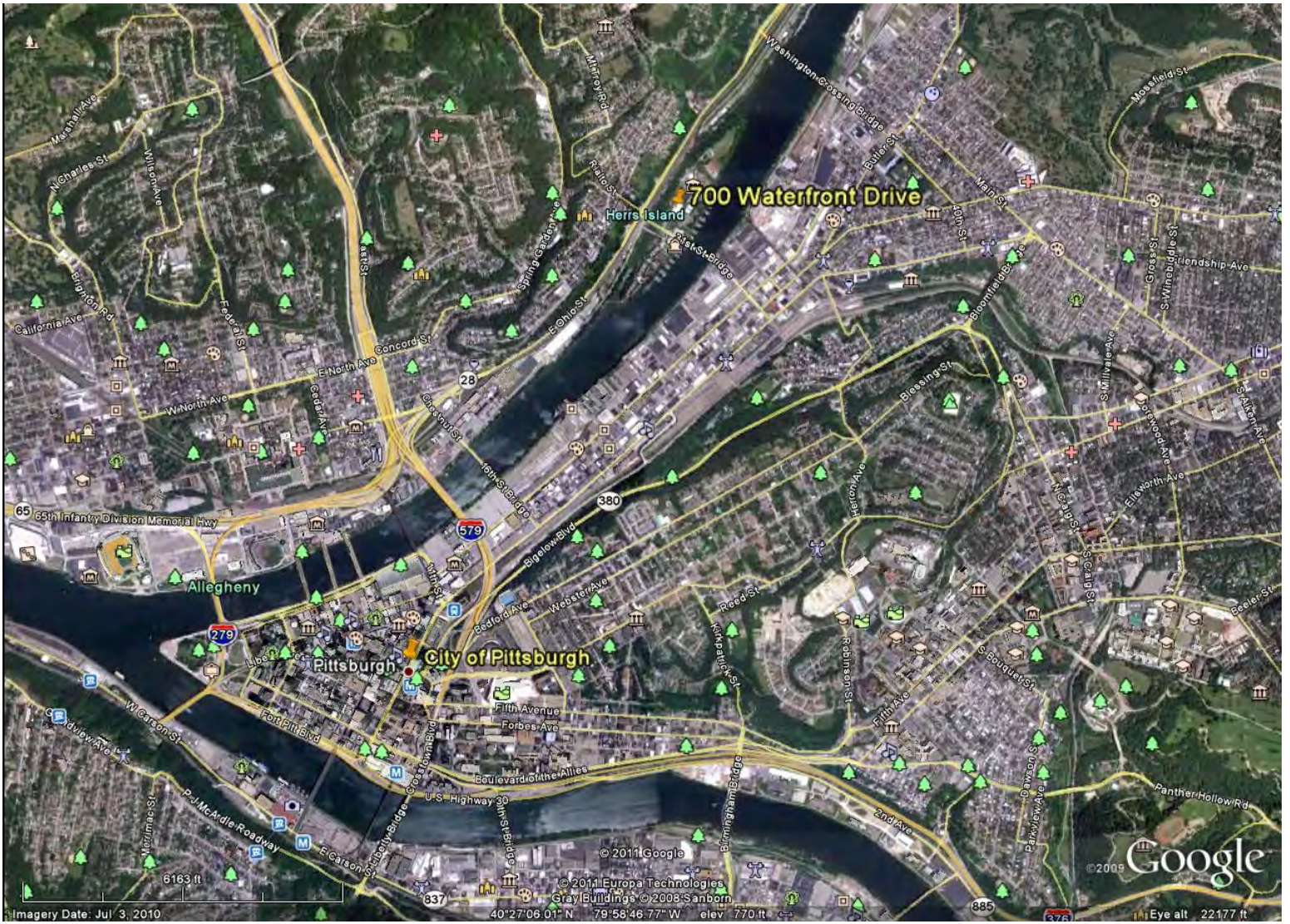

GENERAL FURNITURE, EQUIPMENT AND POWER NOTICE
 1. Client's responsibility is to provide accurate information regarding the intended use of the space and any special requirements.
 2. The architect is not responsible for the accuracy of the client's information.
 3. The architect is not responsible for the accuracy of the client's information.
 4. The architect is not responsible for the accuracy of the client's information.
 5. The architect is not responsible for the accuracy of the client's information.
 6. The architect is not responsible for the accuracy of the client's information.
 7. The architect is not responsible for the accuracy of the client's information.
 8. The architect is not responsible for the accuracy of the client's information.
 9. The architect is not responsible for the accuracy of the client's information.
 10. The architect is not responsible for the accuracy of the client's information.

4 Smithfield Street Floor 12
 Pittsburgh, Pennsylvania 15222
 412.281.0001 412.281.0002

- general notes**
1. All work shall be in accordance with the contract documents and the applicable building codes.
 2. All work shall be in accordance with the contract documents and the applicable building codes.
 3. All work shall be in accordance with the contract documents and the applicable building codes.
 4. All work shall be in accordance with the contract documents and the applicable building codes.
 5. All work shall be in accordance with the contract documents and the applicable building codes.
 6. All work shall be in accordance with the contract documents and the applicable building codes.
 7. All work shall be in accordance with the contract documents and the applicable building codes.
 8. All work shall be in accordance with the contract documents and the applicable building codes.
 9. All work shall be in accordance with the contract documents and the applicable building codes.
 10. All work shall be in accordance with the contract documents and the applicable building codes.

Client:
 Acumatic USA, Inc.
 440 Allegheny Drive
 Pittsburgh, PA 15238

Project Location:
 Acumatic
 Washington's Landing
 700 Waterfront Drive
 Pittsburgh, PA 15222

Second Floor Furniture, Fixture, Equipment and Partial Power Plan

1 Second Floor Furniture, Fixture, Equipment and Partial Power Plan

As Noted	Sheet No.
11/11/2010	A205
13 26	Project #1053